

NOTES: UNLESS OTHERWISE SPECIFIED.

1. MATERIAL: ALUM 6061-T6.
2. BREAK SHARP EDGES .12mm TO 0.4mm CHAMFER/RADII.
3. SHEET METAL TOLERANCE: .XX±0.20mm; X±0.38mm
HOLE-TO-HOLE SAME SURFACE ±0.12mm
HOLE-TO-EDGE ±.25mm.
HOLE-TO-FOLD ±.38mm.
FOLD-TO-FOLD ±.51mm.
FOLD-TO-EDGE ±.38mm.
EDGE-TO-EDGE ±.25mm.
4. PARTS TO BE CLEAN AND FREE FROM OIL OR ANY CONTAMINATION.
5. PACKAGE PARTS WITH P/N, REV LEVEL, AND P.O. ON PACKAGE.
6. OVAL DIMENSIONS AND NOTES INDICATE INCOMING INSPECTION.
7. CERTIFICATE OF COMPLIANCE REQUIRED FOR EACH SHIPPED LOT.

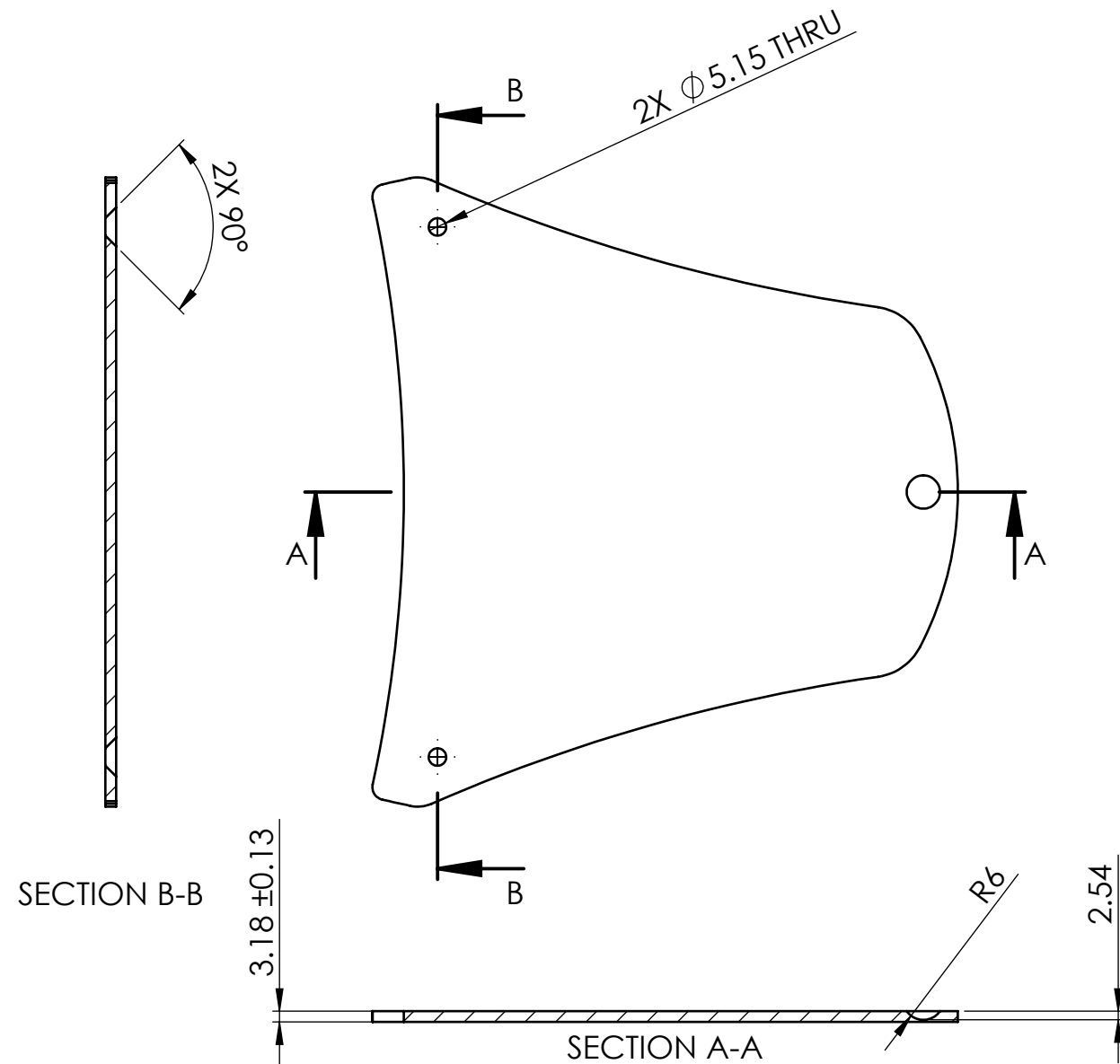

REVISIONS			
REV	ECO NO.	DESCRIPTION	DRAWN DATE
V1	N/A	PRODUCTION RELEASE	5/5/2016

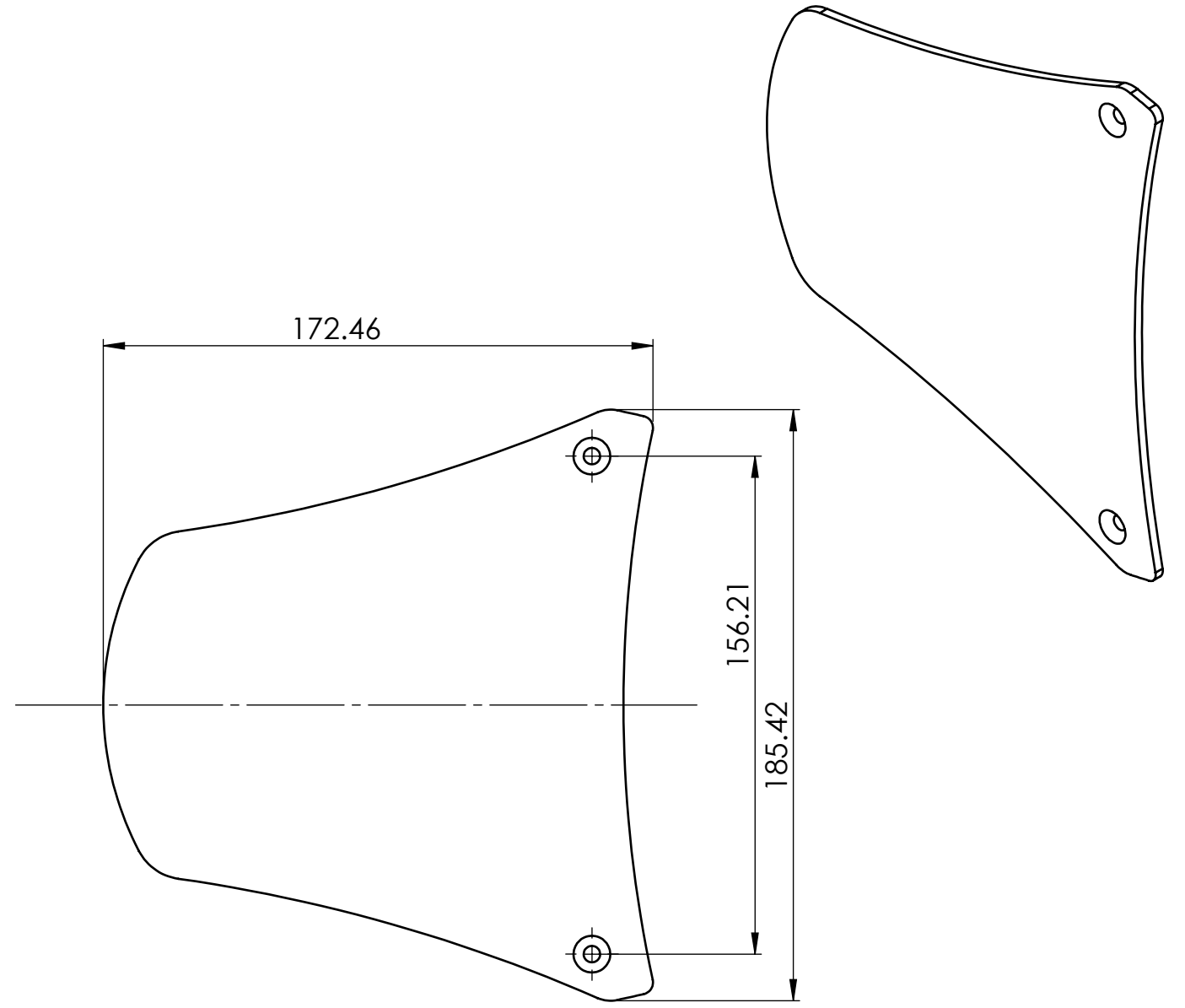

UNLESS OTHERWISE SPECIFIED DIMENSIONS ARE IN MM. TOLERANCES AS FOLLOWS: LINEAR: mm±.2 ANGULAR: X°±1°	3RD ANGLE PROJECTION				120 Newport Center Drive Newport Beach, CA 92660 United States www.cepglobal.com 1-800-483-8020	
	MATERIAL	6061-T6 AL	TITLE			
INTERPRET DIMENSIONS & TOLERANCES PER ASME Y14.5-2009.	FINISH	NONE	FOOT PLATE			
	PROJECT	CEP				
PROPRIETARY AND CONFIDENTIAL THE INFORMATION CONTAINED IN THIS DRAWING IS THE SOLE PROPERTY OF CUTTING EDGE PRODUCTS CORPORATION. ANY REPRODUCTION IN PART OR A WHOLE WITHOUT THE WRITTEN PERMISSION OF CUTTING EDGE PRODUCTS CORPORATION IS PROHIBITED.	ORIGINATOR	NAME	DATE	SIZE	DWG NO.	REV
	DESIGNED BY	B. SPERKO	11/2/2015	B	C00015	V1
	DRAWN BY	A. GIFFORD	5/5/20216	SCALE 1:2	SW FILE NAME: C00015 Foot Plate V1	SHEET 1 OF 1