

NOTES: UNLESS OTHERWISE SPECIFIED.

1. MATERIAL: POLYCARBONATE, FLAMMABILITY RATING: UL94V1 IN PART THICKNESS, COLOR: TRANSLUCENT WHITE
PROVIDE MATERIAL CERTIFICATION WITH EACH SHIPMENT OF PARTS.

2. TEXTURE A-SIDE: STANDARD TEXTURE = POLISHED SPI FINISH A-1

3. TEXTURE B-SIDE: SPI D-2

- 4. 3D CAD GEOMETRY DEFINES FEATURES NOT DIMENSIONED. ALL DIMENSIONS IN MM. TOLERANCES: 1 TO 20MM ±.1, 21 TO 100 ±.15, 101 TO 160 ±.325, FOR EACH 20MM OVER 160 ADD ±.08
- 5. CORNER RADII 0.13MM NOMINAL.
- 6. TYPICAL DRAFT ANGLE TO BE 1 DEGREE MAX. SEE CAD MODEL FOR ANGLE DETAILS.
- 7. PARTS TO BE CLEAN AND FREE FROM MOLD RELEASE OR ANY CONTAMINATION.
- 8. OVAL DIMENSIONS AND NOTES INDICATE INSPECTION DIMENSIONS.

REVISIONS			
REV	ECO NO.	DESCRIPTION	DRAWN DATE
V1	N/A	PRODUCTION RELEASE	5/5/2016

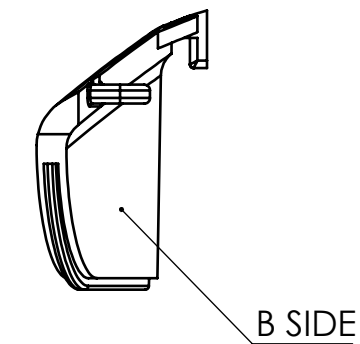
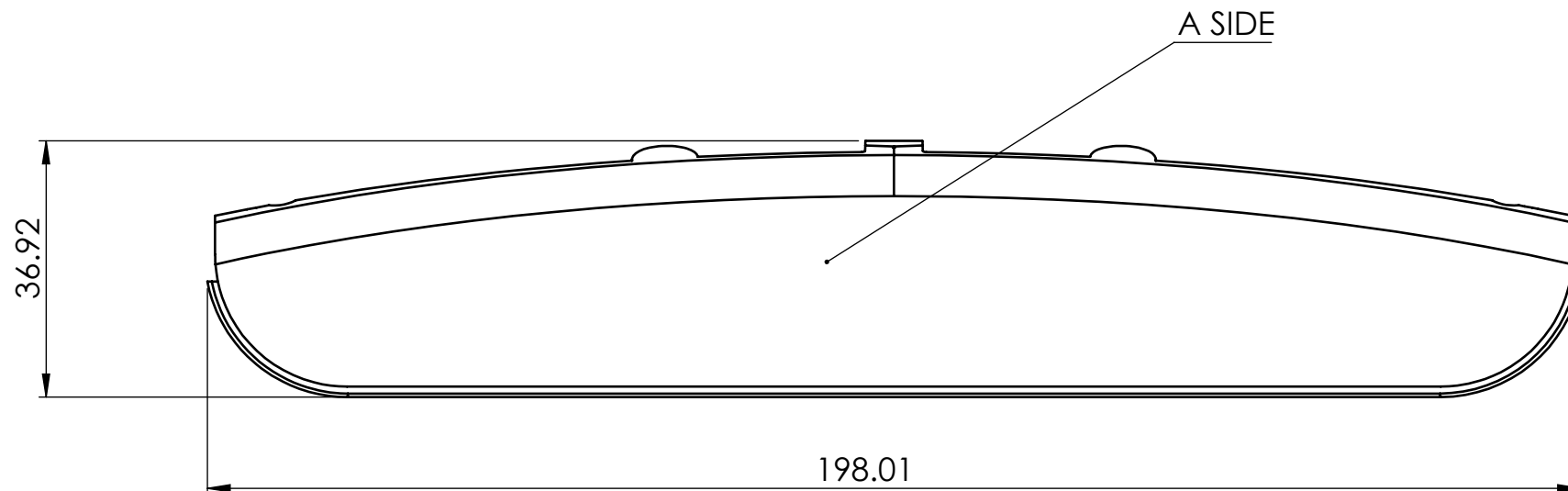
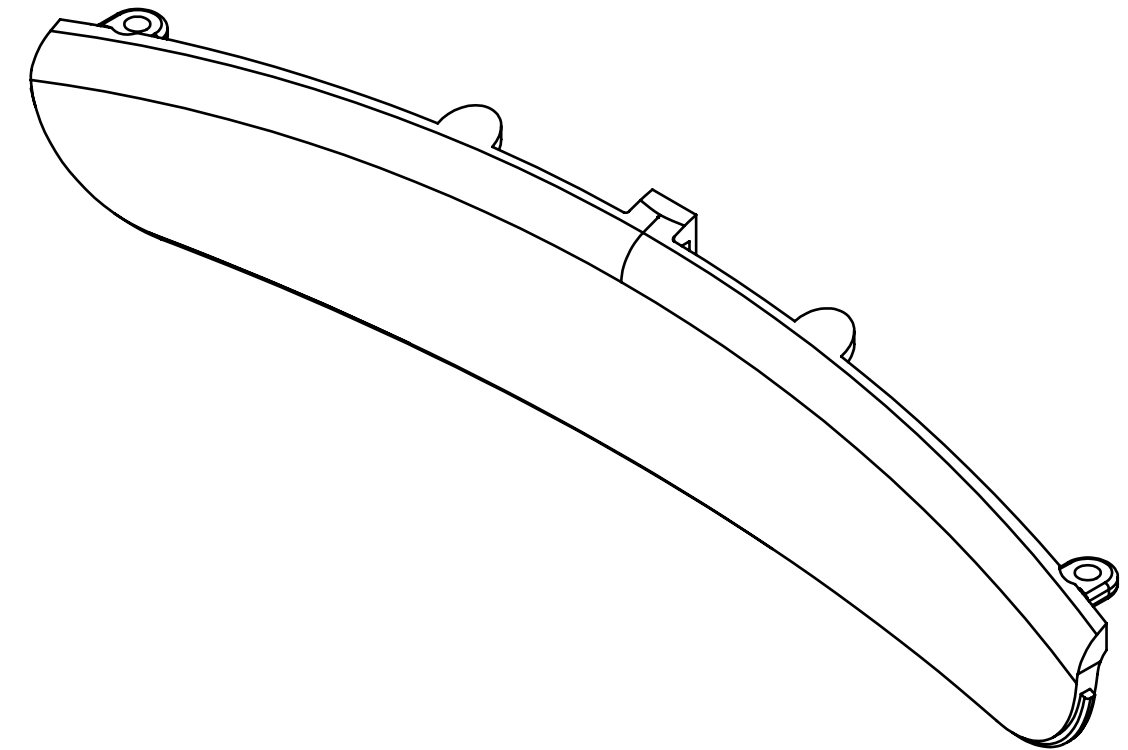
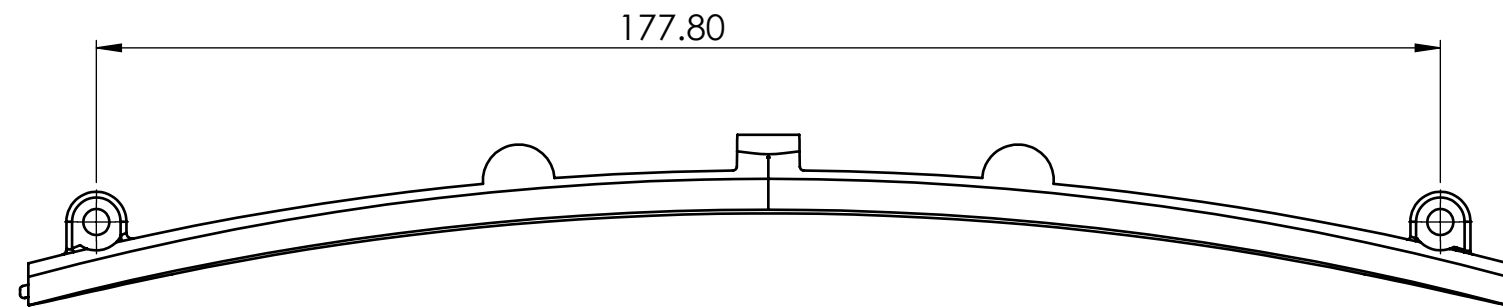

UNLESS OTHERWISE SPECIFIED DIMENSIONS ARE IN MM. TOLERANCES AS FOLLOWS: LINEAR: mm±.2 ANGULAR: X°±1°	3RD ANGLE PROJECTION				CUTTING EDGE PRODUCTS		120 Newport Center Drive Newport Beach, CA 92660 United States www.cepglobal.com 1-800-483-8020	
	MATERIAL	SEE NOTES		TITLE				
INTERPRET DIMENSIONS & TOLERANCES PER ASME Y14.5-2009.	FINISH	SEE NOTES		LED LENS				
PROPRIETARY AND CONFIDENTIAL THE INFORMATION CONTAINED IN THIS DRAWING IS THE SOLE PROPERTY OF CUTTING EDGE PRODUCTS CORPORATION. ANY REPRODUCTION IN PART OR A WHOLE WITHOUT THE WRITTEN PERMISSION OF CUTTING EDGE PRODUCTS CORPORATION IS PROHIBITED.	PROJECT	CEP		SIZE	DWG NO.	C00021		REV
	ORIGINATOR	NAME	DATE	B				V1
	DESIGNED BY	B. SPERKO	11/1/2015					
DRAWN BY	A. GIFFORD	5/5/20216	SCALE	1:1	SW FILE NAME:	C00021 LED Lens V1		SHEET 1 OF 1